

MDE Series
Molding Power Inductors
Size 0412



FEATURES

- High rated current
- Frequency up to 3 MHz
- 125 C
 - SSD modules

APPLICATION

-
-
-
-
-
-

Dimensions: [mm]

Land Pattern: [mm]

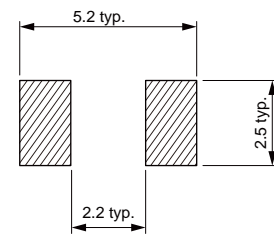
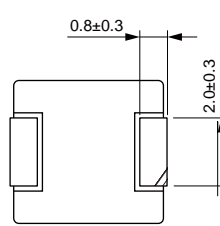
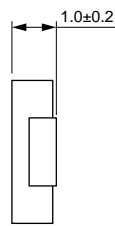
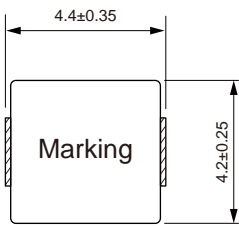

Electrical Properties:

| | | | | | |
|--|--|--|------|--|------|
| | | | | | |
| | | | | | |
| | | | | | |
| | | | | | |
| | | | | | |
| | | | | | 3.25 |
| | | | 83.5 | | 2.75 |
| | | | 195 | | |

Saturation Current will cause L to drop approximately 30%

Temperature Rise Current: The actual value of DC current when the temperature rise is $\Delta T=40^{\circ}\text{C}$

Typical Electrical Characteristics:

Inductance vs DC Current Characteristics:

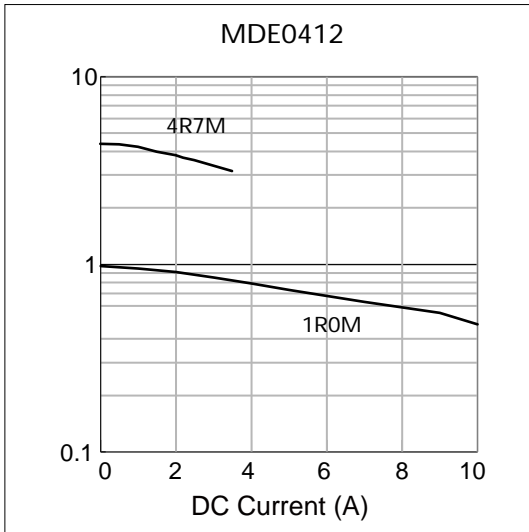

Temperature Rise vs DC Current Characteristics:

